

THIS DRAWING IS UNPUBLISHED. RELEASED FOR PUBLICATION
 © COPYRIGHT BY TYCO ELECTRONICS CORPORATION. ALL RIGHTS RESERVED.

| LOC | DIST | REVISIONS | | | | | |
|-----|------|-----------|-----|---------------------------|---------|-----|------|
| | | P | LTR | DESCRIPTION | DATE | DWN | APVD |
| CM | 00 | C | | REVISED PER ECO-07-003747 | 27FEB07 | KW | DB |

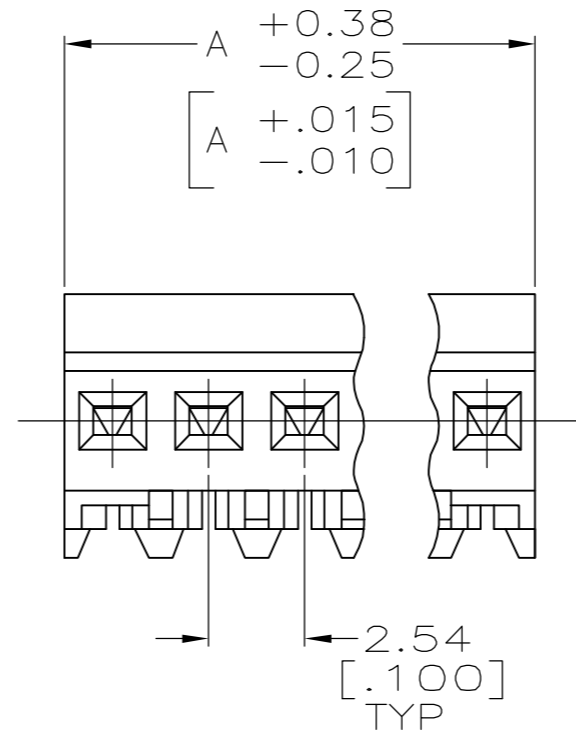
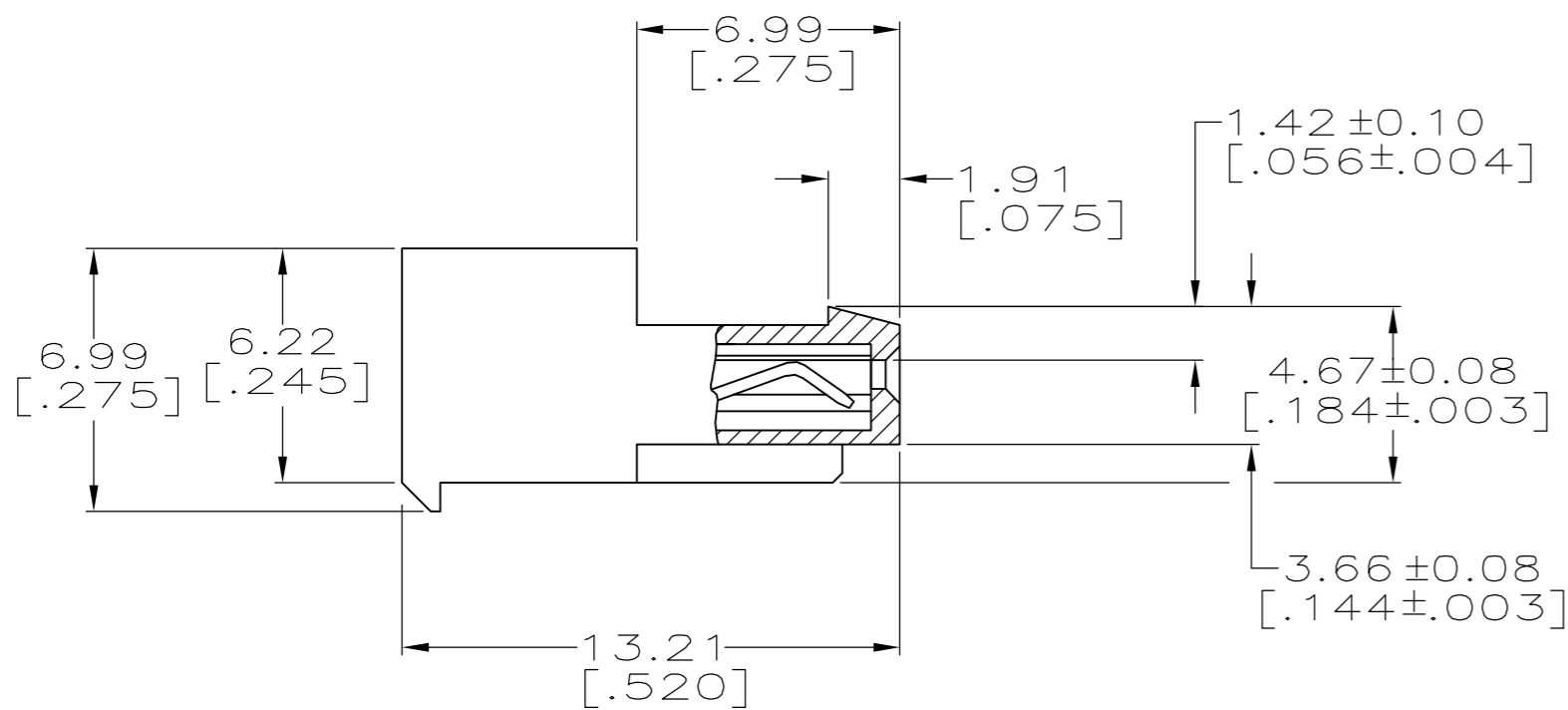
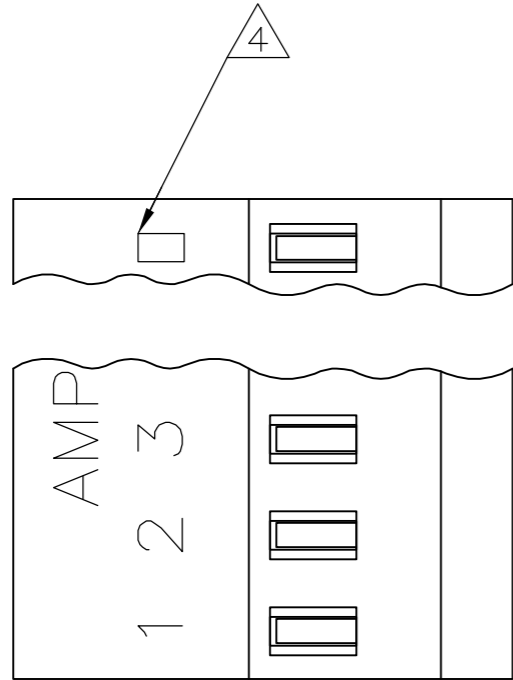

- △ MATERIAL: CONNECTOR-NYLON UL94V-0 (BLACK).
 CONTACTS-0.30 [.012] THICK COPPER ALLOY
 0.00076 [.000030] GOLD IN CONTACT AREA
 WITH BRIGHT TIN-LEAD FOR 644315-2 THRU
 644315-6, MATTE WHISKER MITIGATED TIN
 FOR 3-644315-2 THRU 4-644315-5 OVER
 NICKEL UNDERPLATE.
- 2. CONTACTS ACCEPT 26 AWG WIRE WITH 1.52[.060] MAX
 INSULATION DIAMETER.
- 3. CONTACTS MUST ACCEPT 0.64±0.03[.025±.001] SQUARE
 POST AND REMAIN LOCKED IN POSITION.
- △ IDENTIFICATION NUMBER FOR LAST CIRCUIT MAY
 NOT APPEAR ON ALL ASSEMBLIES.
- 5. DIMENSIONS IN BRACKETS ARE IN INCHES.
- 6. HOUSING FEATURES ARE: CLOSED END WITH LOCKING
 RAMP.

| | | |
|---------------|-------------------|------------|
| | | |
| 38.10 [1.500] | 15 | 4-644315-5 |
| | | |
| 27.94 [1.100] | 11 | 4-644315-1 |
| | | |
| 15.24 [.600] | 6 | 3-644315-6 |
| 10.16 [.400] | 4 | 3-644315-4 |
| 5.08 [.200] | 2 | 3-644315-2 |
| | | |
| 15.24 [.600] | 6 | 644315-6 |
| 10.16 [.400] | 4 | 644315-4 |
| 5.08 [.200] | 2 | 644315-2 |
| DIM A | NO OF CIRCUITS | PART NO |

METRIC

| | | | | |
|--|---|----------------------------------|---|-----------|
| THIS DRAWING IS A CONTROLLED DOCUMENT. | | DWN K. WHITAKER 21JULY2005 | Tyco Electronics Corporation Harrisburg, Pa 17105-3608 | |
| DIMENSIONS: mm [INCHES] | TOLERANCES UNLESS OTHERWISE SPECIFIED: | CHK D. BOSSI 21JULY2005 | NAME | |
| | 0 PLC ± - | APVD D. BOSSI 21JULY2005 | MTA 100 CONNECTOR ASSEMBLY, 26 AWG,UL94V-0, SPECIAL | |
| | 1 PLC ± - | PRODUCT SPEC | SIZE | CAGE CODE |
| | 2 PLC ± - | APPLICATION SPEC | A2 | 00779 |
| | 3 PLC ± 0.13 [.005] | 114-1019 | DRAWING NO | C=644315 |
| | 4 PLC ± - | WEIGHT | RESTRICTED TO | - |
| | ANGLES ± - | CUSTOMER DRAWING | SCALE | 5:1 |
| MATERIAL △ | FINISH △ | | SHEET | 1 OF 1 |
| | | | REV | C |